

DEPARTMENT OF PUBLIC WORKS
FACILITIES DESIGN AND CONSTRUCTION
2079 EAST NORTH STREET
CLEVELAND, OHIO 44115



Christopher P. Dewey, License #13313
Expiration Date 12/31/2025

CLIENT APPROVAL
AUTHORIZED REPRESENTATIVE SIGNATURE:

PRINTED NAME:

DATE SIGNED:

CUYAHOGA COUNTY
VETERANS SERVICE COMMISSION
HEADQUARTERS RELOCATION
3950 CHESTER AVENUE, CLEVELAND, OH 44114
RQ # 14327

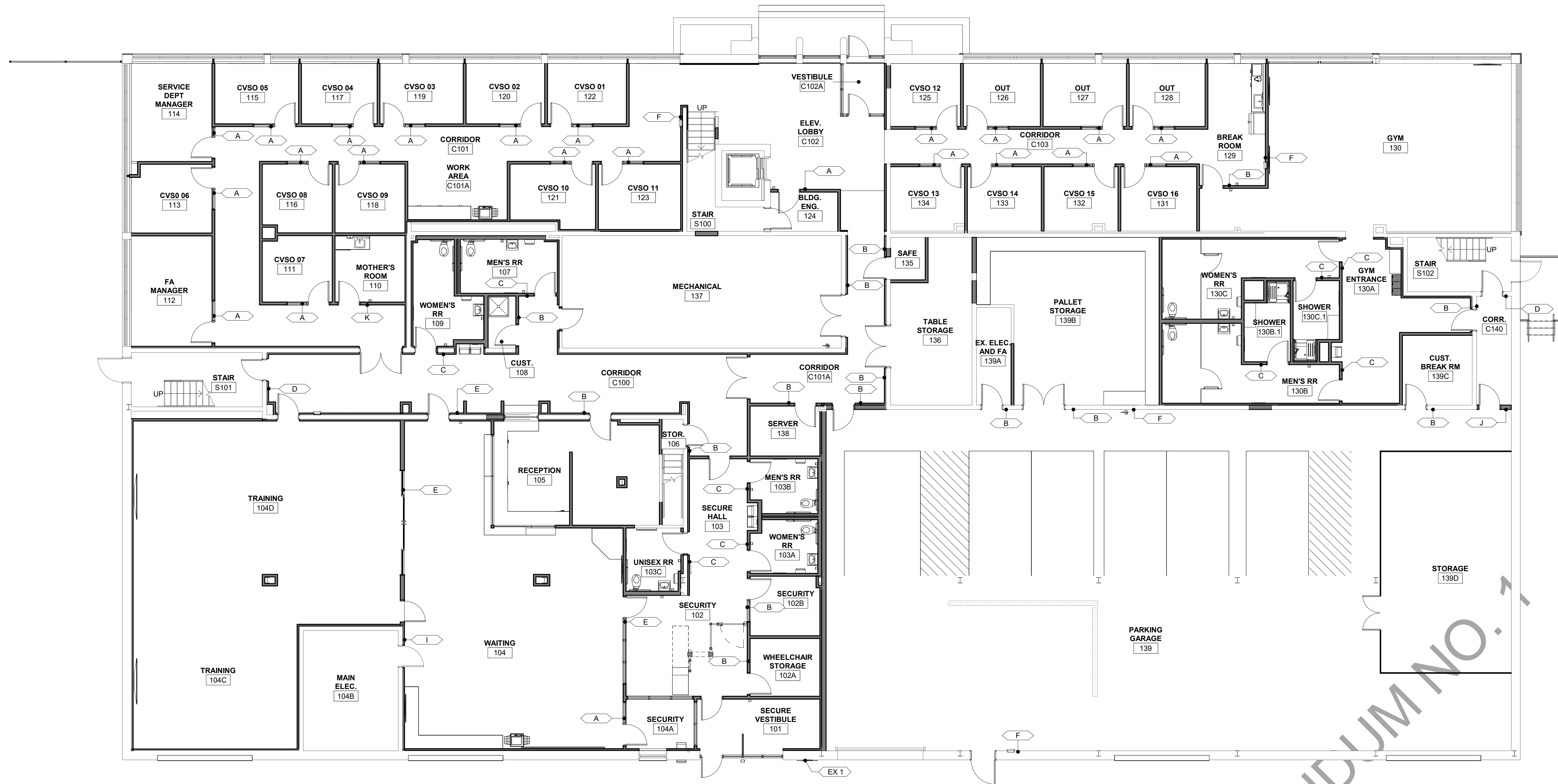

1 FIRST FLOOR SIGNAGE PLAN

A9.05 1/8" = 1'-0"



ROOM NO.	ROOM NAME	QTY.	TAG	SIGNAGE TEXT	INSERT TEXT
102A	WHEELCHAIR STORAGE	1	B	-	INSERT TEXT TO BE PROVIDED BY OWNER, GLASS BACKER
102B	SECURITY	1	B	STORAGE	GLASS BACKER
103A	WOMEN'S RR	1	C	WOMEN W/ PICTOGRAM	-
103B	MEN'S RR	1	C	MEN W/ PICTOGRAM	-
103C	UNISEX RR	1	C	FAMILY W/ PICTOGRAM	-
104	WAITING	1	B	WAITING ROOM	-
104	WAITING	2	E	WAITING ROOM/ MAX OCCUPANCY: TBD	-
104A	SECURITY	1	A	-	INSERT TEXT TO BE PROVIDED BY OWNER, GLASS BACKER
104B	MAIN ELEC.	1	I	MAIN ELECTRICAL ROOM	-
104D	TRAINING	1	E	TRAINING ROOM/ MAX. OCCUPANCY 104	GLASS BACKER
105	RECEPTION	1	B	RECEPTION	-
106	STOR.	1	B	STORAGE	-
107	MEN'S RR	1	C	MEN W/ PICTOGRAM	-
108	CUST.	1	B	-	-
109	WOMEN'S RR	1	C	WOMEN W/ PICTOGRAM	-
110	MOTHER'S ROOM	1	K	MOTHERS ROOM W/ PICTOGRAM	-
111	CVSO 07	1	A	-	INSERT TEXT TO BE PROVIDED BY OWNER, GLASS BACKER
112	FA MANAGER	1	A	-	INSERT TEXT TO BE PROVIDED BY OWNER, GLASS BACKER
113	CVSO 06	1	A	-	INSERT TEXT TO BE PROVIDED BY OWNER, GLASS BACKER
114	SERVICE DEPT MANAGER	1	A	-	INSERT TEXT TO BE PROVIDED BY OWNER, GLASS BACKER
115	CVSO 05	1	A	-	INSERT TEXT TO BE PROVIDED BY OWNER, GLASS BACKER
116	CVSO 08	1	A	-	INSERT TEXT TO BE PROVIDED BY OWNER, GLASS BACKER
117	CVSO 04	1	A	-	INSERT TEXT TO BE PROVIDED BY OWNER, GLASS BACKER
118	CVSO 09	1	A	-	INSERT TEXT TO BE PROVIDED BY OWNER, GLASS BACKER
119	CVSO 03	1	A	-	INSERT TEXT TO BE PROVIDED BY OWNER, GLASS BACKER
120	CVSO 02	1	A	-	INSERT TEXT TO BE PROVIDED BY OWNER, GLASS BACKER
121	CVSO 10	1	A	-	INSERT TEXT TO BE PROVIDED BY OWNER, GLASS BACKER
122	CVSO 01	1	A	-	INSERT TEXT TO BE PROVIDED BY OWNER, GLASS BACKER
123	CVSO 11	1	A	-	INSERT TEXT TO BE PROVIDED BY OWNER, GLASS BACKER
124	BLDG. ENG.	1	A	-	INSERT TEXT TO BE PROVIDED BY OWNER, GLASS BACKER

ROOM NO.	ROOM NAME	QTY.	TAG	SIGNAGE TEXT	INSERT TEXT
125	CVSO 12	1	A	-	INSERT TEXT TO BE PROVIDED BY OWNER, GLASS BACKER
126	OUT	1	A	-	INSERT TEXT TO BE PROVIDED BY OWNER, GLASS BACKER
127	OUT	1	A	-	INSERT TEXT TO BE PROVIDED BY OWNER, GLASS BACKER
128	OUT	1	A	-	INSERT TEXT TO BE PROVIDED BY OWNER, GLASS BACKER
129	BREAK ROOM	1	F	FIRE EXTINGUISHER W/ PICTOGRAM	-
130	GYM	1	B	GYM	-
130A	GYM ENTRANCE	1	B	GYM	-
130B	MEN'S RR	1	C	MEN W/ PICTOGRAM	-
130B.1	SHOWER	1	C	-	-
130C	WOMEN'S RR	1	C	WOMEN W/ PICTOGRAM	-
130C.1	SHOWER	1	C	-	-
131	CVSO 16	1	A	-	INSERT TEXT TO BE PROVIDED BY OWNER, GLASS BACKER
132	CVSO 15	1	A	-	INSERT TEXT TO BE PROVIDED BY OWNER, GLASS BACKER
133	CVSO 14	1	A	-	INSERT TEXT TO BE PROVIDED BY OWNER, GLASS BACKER
134	CVSO 13	1	A	-	INSERT TEXT TO BE PROVIDED BY OWNER, GLASS BACKER
135	SAFE	1	B	STORAGE	-
136	TABLE STORAGE	1	B	STORAGE	-
137	MECHANICAL	1	B	MECHANICAL	-
138	SERVER	1	B	SERVER	-
139	PARKING GARAGE	1	B	PARKING	-
139	PARKING GARAGE	1	F	FIRE EXTINGUISHER W/ PICTOGRAM	-
139A	EX. ELEC. AND FA	1	B	ELECTRICAL ROOM	-
139A	EX. ELEC. AND FA	1	H	MAIN FIRE ALARM PANEL	-
139B	PALLET STORAGE	1	B	STORAGE	-
139C	CUST. BREAK RM	1	B	BREAK ROOM	-
C140	CORR.	1	J	SPRINKLER MAIN SHUT-OFF	-
S100	STAIR	1	F	FIRE EXTINGUISHER W/ PICTOGRAM	-
S101	STAIR	1	D	STAIRS W/ PICTOGRAM	-
S102	STAIR	1	D	STAIRS W/ PICTOGRAM	-

ORIGINAL DRAWING FURNISHED BY THE DEPARTMENT OF PUBLIC WORKS, FACILITIES DESIGN AND CONSTRUCTION SECTION.

NOTE: THESE PLANS ARE SCHEMATIC ONLY. VERIFY EXISTING CONDITIONS AND ALL DIMENSIONS IN FIELD.



REV. NO.	DESCRIPTION
1	ISSUED FOR PERMIT 02.01.2024
1	ADDENDUM 1

DRAWN	DATE
VAA	04.02.2024
CHECKED	PROJECT NO.
CPD	2227
SHEET NO.	A9.05